

GDLM-0004-WTA-18



Key Features:

High Reliability
 Compactable size
 Auto Power Control
 Low Power Consumption
 Wide Operating Temperature

Applications:

Rotary Laser Levels
 Surveying Equipment
 Laser Alignment & Pointing

Model Number		GDLM-0004-WTA-18			
Optical Parameters		Specs			Conditions
		Min	Typ	Max	
Wavelength		531nm	532nm	533nm	
Output Power		3.5mW	3.65mW	4.0mW	At 25 °C
Power Stability	2hours @ Constant Temp	-	-	+/-5%	APC
	Over Operating Temp Range	2.7mW	-	4.7mW	
Operating Temperature (Case)		-	0~+45 °C	-	APC
Residual IR		-	-	1%	
Beam Diameter		-	-	27mm	At 60m
Beam Divergence		-	-	0.45mrad	Full angle
Roundness		70%	80%	100%	
Warm Up Time		-	1s	-	0~45 °C
Electrical Parameters					
LD Working Current		-	255mA ^①	400mA	0~45 °C
LD Working Voltage		1.6V	1.9V	2.2V	
Monitor Current		5uA	-	110uA	
GDL Power Consumption		-	0.51W ^②	0.88W	0~45 °C
Mechanical Parameters					
Laser Head Dimensions	Length	37.8mm	38mm	38.2mm	
	Diameter	10.95mm	11mm	11.05mm	
Beam Alignment Tolerance	Position(Δr)	-	0.3mm	0.5mm	
	Angle	-	7mrad	17.5mrad	
Reliability					
Storage Temperature		-	-20 to +60 °C	-	
Shock		-	1000g, 1ms, 6 shocks	-	3 axes, 2 shocks/axis
Vibration		-	20~2000Hz, 0.02g ² /Hz	-	3 axes, 1hr/axis
Expected Lifetime (MTTF)		10000hrs	-	-	Room temperature

Note: ^①3.65mW at 25 °C

^②3.65mW at 25 °C

Typical Output Performance

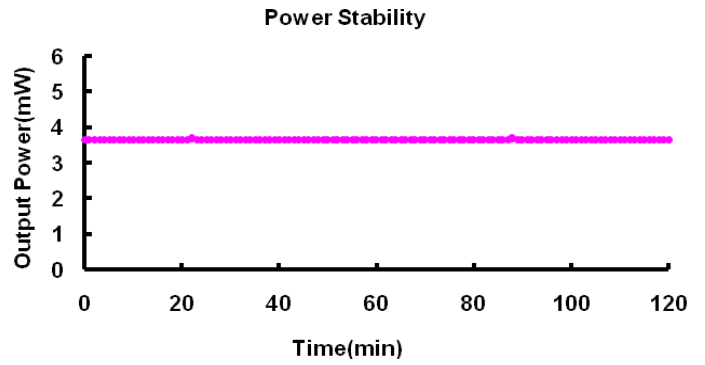
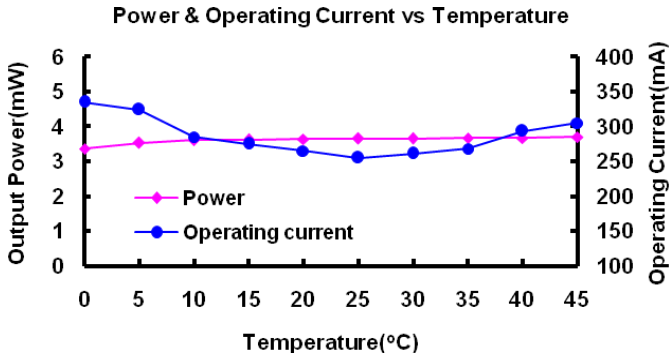

Dimensions and Pin Configuration (Unit: mm)

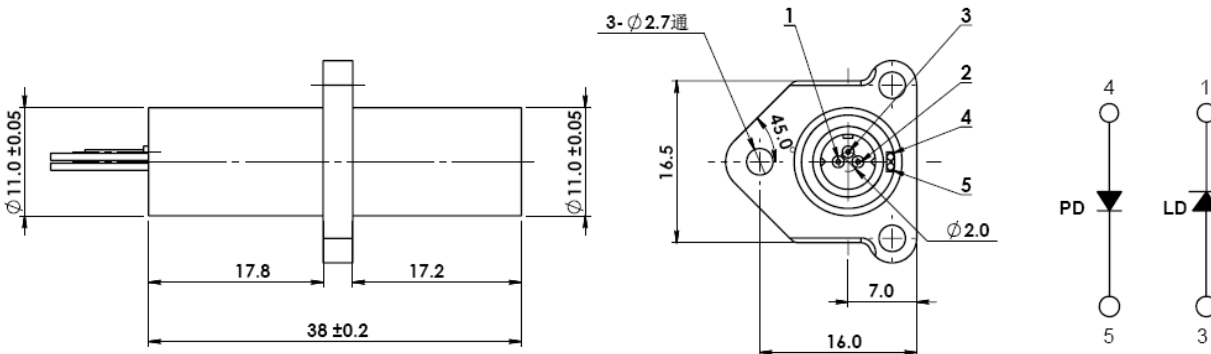

Pin Configurations : 1. LD- 2. None 3. LD+
 4. PD+ 5. PD-