

## Mounted Laser Diode

L488P060MLD



### Description

Thorlabs' mounted Ø5.6 mm can package blue laser diode is a compact light source suited to many applications. Our lasers are fully compatible with our entire line of Laser Diode and TEC Controllers, as well as our selection of Laser Diode Mounts and Collimation Solutions.

### Specifications

#### Absolute Maximum Ratings

Specification	Symbol	Value
Optical Output Power	$P_o$	80 mW
LD Reverse Voltage	$V_r(LD)$	5 V
PD Reverse Voltage	$V_r(PD)$	20 V
Storage Temperature	$T_s$	-40 to 85 °C
Operating Case Temperature	$T_c$	0 to 60 °C



#### Typical and Measured Characteristics

Specification	Symbol	Min	Typical	Max	Measured Value
Optical Output Power <sup>a</sup>	$P_o$	-	-	60 mW	
Peak Wavelength <sup>b</sup>	$\lambda_p$	483 nm	488 nm	493 nm	
Threshold Current <sup>a</sup>	$I_{th}$	-	30 mA	50 mA	
Operating Current <sup>b</sup>	$I_{op}$	-	100 mA	130 mA	
Slope Efficiency <sup>a</sup>	$\eta$	0.6 W/A	0.9 W/A	-	
Operating Voltage <sup>b</sup>	$V_{op}$	-	5.6 V	6.2 V	
FWHM Beam Divergence <sup>b</sup>	$\theta_{//}$	7.0°	10.0°	13.0°	
	$\theta_{\perp}$	20.0°	23.5°	27.0°	
Emission Point Accuracy Angle <sup>b</sup>	$\Delta\theta_{//}$	-2.5°	-	2.5°	
	$\Delta\theta_{\perp}$	-5.0°	-	5.0°	
Monitor Current <sup>b, c</sup>	$I_m$	0.6 mA	1.0 mA	1.4 mA	

a) CW Operations

b)  $P_o = 60$  mW

c) Monitor Current is short time power reference purpose only. Not warranted for accuracy. The internal photodiode is for reference evaluation purposes only. No warranty is offered on monitor current.

#### Pin Code Style B

Pin	Connection
1	LD Anode
2	PD Anode
3	Common/Case

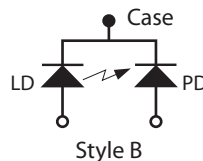

NOTICE

To avoid equipment damage from electrostatic discharge:  
Wear ESD wriststrap when handling this device.

## Drawings

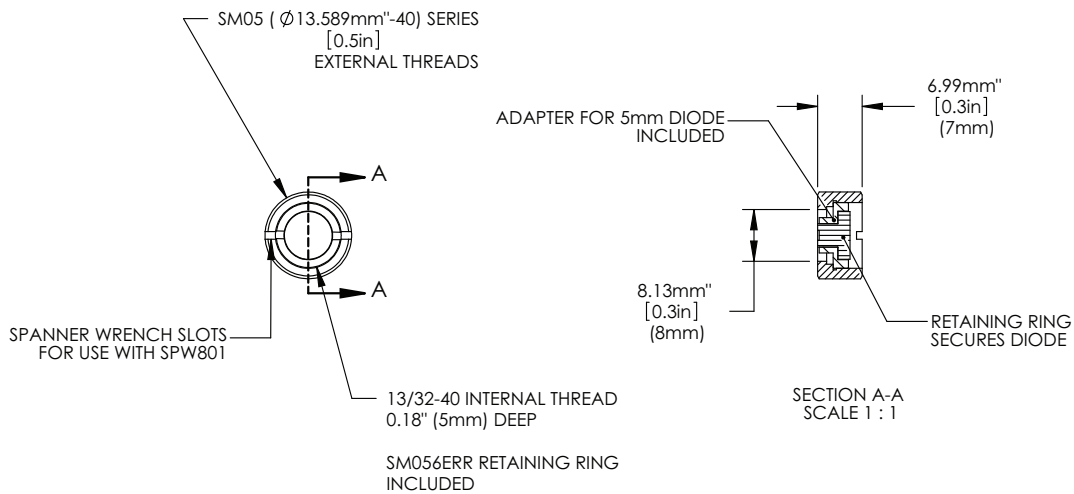
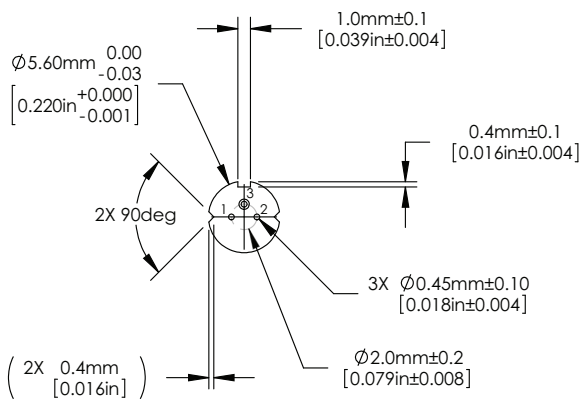
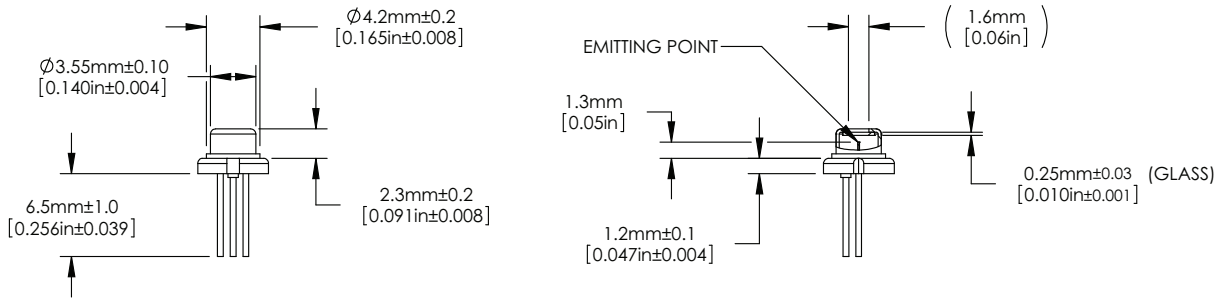

### USA, Canada, and South America

Thorlabs, Inc.  
435 Route 206  
Newton, NJ 07860, USA

Tel: 973-579-7227  
Fax: 973-300-3600

### Europe

Thorlabs GmbH  
85221 Dachau, Germany  
Tel: +49-(0)8131-5956-0

**Scandinavia**  
Thorlabs Sweden AB  
400 20 Göteborg, Sweden  
Tel: +46-31-733-30-00

### UK and Ireland

Thorlabs LTD.  
Cambridgeshire CB7 4EX, GB  
Tel: +44 (0)1353-654440

**Japan and Asia**  
Thorlabs Japan Inc.  
Toshima-ku, Tokyo 170-0013, Japan  
Tel: +81-3-5979-8889

### France

Thorlabs SAS  
78600 Maisons-Laffitte, France  
Tel: +33 (0) 970 444 844

**China**  
Thorlabs China  
Shanghai, China  
Tel: +86 (0)21-32513486

