

808nm, 170mW Wavelength Stabilized Lasers

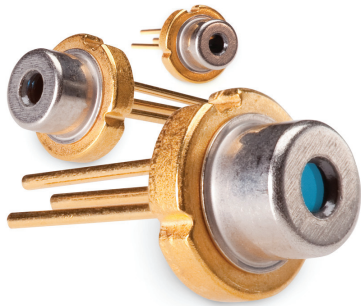

Single Frequency
Wavelength Stability: $\sim 0.015\text{nm}/^\circ\text{C}$

Ondax's 808nm Wavelength Stabilized Laser is a single mode, single frequency laser packaged in an ultra-compact, TO-can footprint. The extremely narrow linewidth, broad temperature operating characteristics, and low power consumption deliver affordable, portable instrument-quality performance for a broad range of instrumentation applications.

All SureLock™ Series lasers are stabilized using the Ondax PowerLocker® Volume Holographic Grating (VHG), ensuring precise, ultra-stable center wavelengths, low temperature dependence, and consistent optical performance over the locked region.

Specifications:

Specification Summary

Parameter	Symbol	Min	Typ	Max	Unit
Output Power	P_o			170	mW
Center Wavelength (vacuum) ¹	L_p	807	808	809	nm
Linewidth (MHz)	$\Delta\lambda$		50		MHz
Central Stabilized Temperature	T_c	15		40	$^\circ\text{C}$
Stabilized Temperature Range	T_r	10	20		$^\circ\text{C}$

Features:

- Single frequency performance
- Narrow linewidth <50 MHz
- Wavelength stability across operating range $0.015\text{nm}/^\circ\text{C}$
- Coherence length >2m
- Compact, hermetically sealed TO footprint

Applications:

- Solid State Laser Pumping
- Photodynamic Therapy
- Bio-instrumentation
- Sensing
- Analytical Instrumentation

Operating Specifications

Parameter	Symbol	Min	Typ	Max	Unit
Threshold Current (CW)	I_{th}		50	70	mA
Operating Current	I_{op}		230	260	mA
Operating Voltage	V_{op}		2	2.4	V
Laser Reverse Voltage	V_{rl}			2	V
Monitoring Output Current	I_m	0.15	0.5	0.9	mA
Beam Divergence, Perpendicular	Q_v	12	16	19	Degrees
Beam Divergence, Parallel	Q_h	6	8	10	Degrees
Off Axis Angle, Perpendicular	dQ_v	-3		3	Degrees
Off Axis Angle, Parallel	dQ_h	-3		3	Degrees
Emitter Size			1 x 3		μm
Differential Efficiency	DE (dP/dI)		1.1		mW/mA
Operating Temperature ²	T_{op}	0		50	$^\circ\text{C}$
Storage Temperature ²	T_s	-10		60	$^\circ\text{C}$
Polarization			100:1		

¹Please specify wavelength at time of ordering ²Non-condensing All specifications are at rated power with a case temperature of 25 $^\circ\text{C}$ unless otherwise noted

808nm, 170mW Wavelength Stabilized Lasers

Stabilized Temperature Range

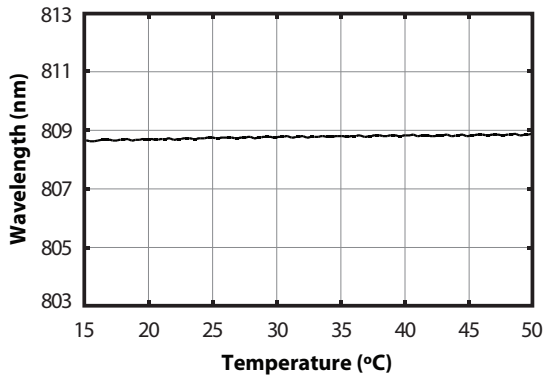

Output Power vs Forward Current (Typical)

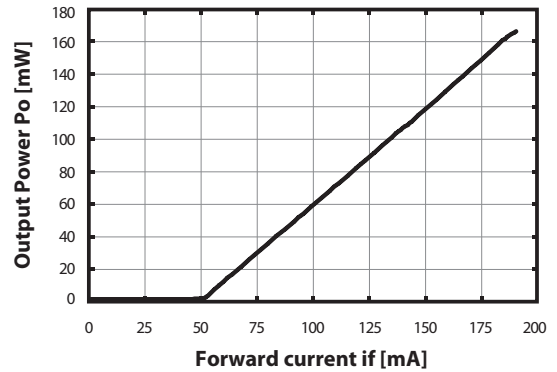

Side View

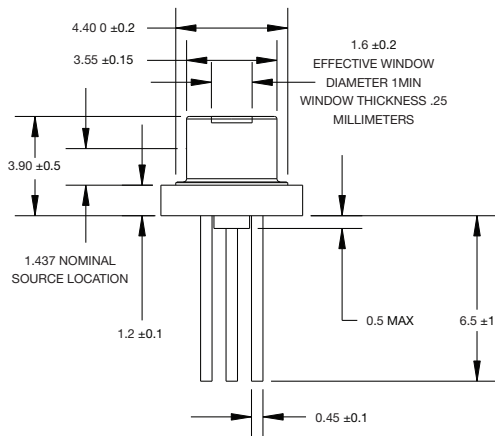

Bottom View

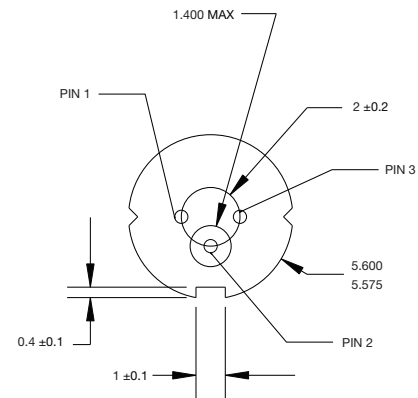

Pinout

Pin	Description
1	Photodiode Anode
2	Case
3	Laser Diode Cathode

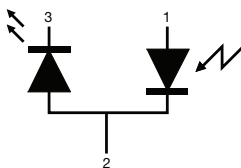

Model Number

TO-808-PLR170

