



SLDP-1550-10-SM



■ Features

- 1550nm
- DFB Laser Diode
- Built-in Photodiodes
- 9um SM Fiber
- Isolation Optional
- Coaxial or B5 Package



■ Absolute Maximum Ratings

Parameter	Symbol	Value	Unit
LD Reverse Voltage	V _r	2.0	V
PD Reverse Voltage	V _{r(PD)}	15	V
Operating Temperature	T _{op}	-20 ~ +50	°C
Storage Temperature	T _{stg}	-40 ~ +100	°C
Lead Soldering Temperature (10sec)	T _{is}	260	°C

■ Initial Electrical/Optical Characteristics

Item	Symbol
Center Wavelength @ 25°C	1550±10nm
Laser Type	DFB
Spectral Width (FWHM)	0.2nm
Output Power	10mW
Fiber Type	SM Fiber
Fiber Core	9um
Recommend Operating Temperature	25°C
Threshold Current (Typ.)	5mA
Operating Current (Typ.)	80mA
Operating Voltage	1.4V
SMSR	35dB
PD Capacitance	10pF
Package Style	Coaxial or B5
Connector	FC/SC/SMA905

CHANGCHUN NEW INDUSTRIES
OPTOELECTRONICS TECH. CO., LTD.

CHANGCHUN NEW INDUSTRIES
OPTOELECTRONICS TECH. CO., LTD.



electronics Tech. Co., Ltd ◆ CONTACT

No.888, Jinhua Road, High-tech Zone, Changchun
130103, China

Phone: +86-431-87033597

Fax: +86-431-87033597

CHANGCHUN NEW INDUSTRIES
OPTOELECTRONICS TECH. CO., LTD.

CHANGCHUN NEW INDUSTRIES
OPTOELECTRONICS TECH. CO., LTD.

Coaxial Package View

mm

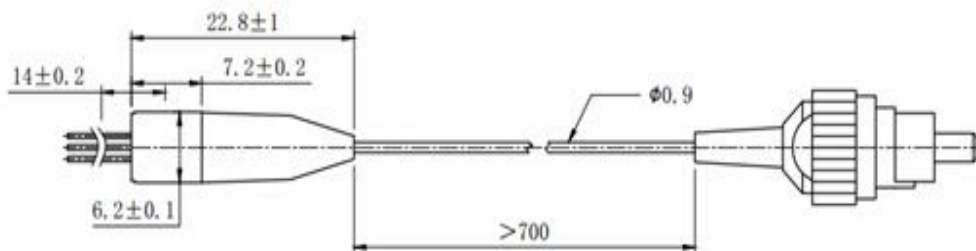

B5 Package View

mm

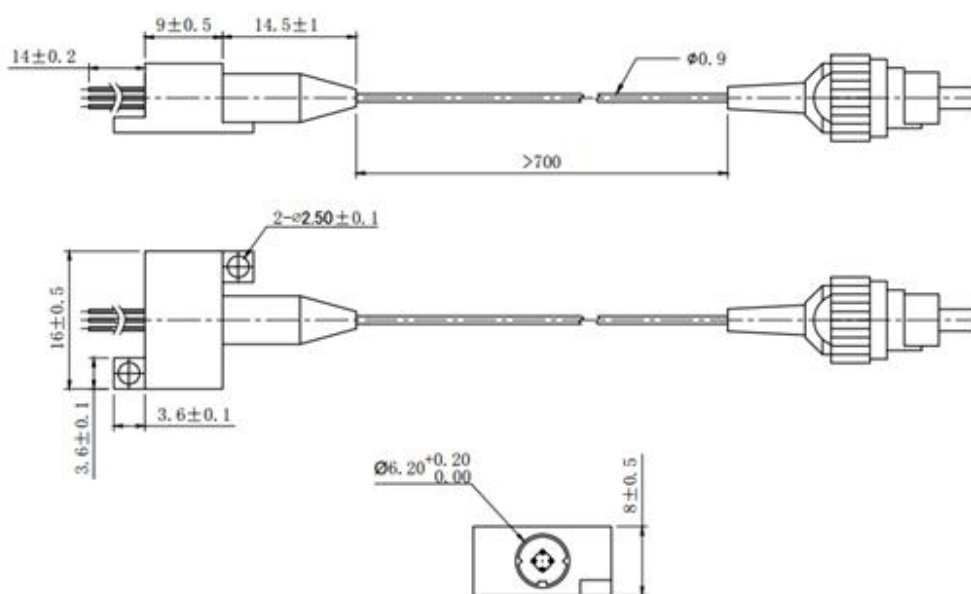

Bottom View

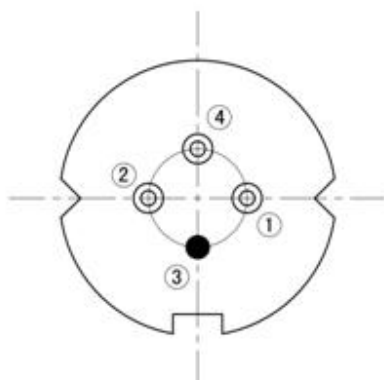

1	PD(+)
2	LD(-)
3	LD(+)
4	PD(-)

Changchun New Industries Optoelectronics Tech. Co., Ltd
<http://www.cnilaser.com>

◆ CONTACT

No.888, Jinhu Road, High-tech Zone, Changchun
 130103, China

Phone: +86-431-87033597

Fax: +86-431-87033597